



ANNUAL REPORT 2022 - 2023

"All the flowers of all the tomorrows are in the seeds of today".

- INDIGENOUS PROVERB



Children's Aid Society
La Société d'aide à l'enfance
NIPISSING & PARRY SOUND



TABLE OF CONTENTS

01

A Year of Transformation
& Growth

02

Here is Where we are Growing &
Where is Where we are Going

03

Service Snapshot

04

Flourishing Youth

05

Nurturing Networks

06

Financials

07

Contact Us

A Year of Transformation and Growth

The past year has been one of growth and innovation at The Children's Aid Society of the District of Nipissing and Parry Sound. As the pandemic faded in everyone's rear-view mirrors, we at no point lost sight of our collective focus, that of always striving to provide the best possible service to those we work with. There are many examples of innovation and growth demonstrated in the organization but we will today focus on a couple of key areas.

All levels of the organization immersed themselves embarking on the implementation stage of *Signs of Safety (SOS)*. The *SOS* model which is based on key principles of respect and inclusion demands ongoing engagement with children, youth, their families and their "networks" at all stages of planning. We are now beginning to see some of the benefits that have resulted from the significant time and energy required to successfully implement this model. We are hearing from some families that they are experiencing our involvement differently, that their interactions with us "*feels different*". Despite the increasing complexity in situations the staff have faced, they have always been committed to participating in countless meetings and sessions to ensure that the necessary shift in our practice occurs.

Another very exciting part of our growth, one we are very proud of is 140 Elmwood. Although we hoped to be in a different place regarding our one-site project, we did not allow that delay to abandon or even slow down our vision of offering a community space where children, youth and families can connect, learn and grow. We realized our goal of a partnership with VON, with the opening of the Nurse Practitioner's office which will ensure vulnerable individuals who cannot at this time access medical services in a consistent manner, do.

We are beyond grateful to Steven Beauchamp and family for their extremely generous donation to help support a redevelopment project that will see a new community kitchen, a tech lab, a boardroom, a youth art studio, and a quiet lounge. We know that the intentional message of our agency's vision for this community space is being realized with community events that have taken place and with others that are planned for the future. The feedback from the community has been incredible, with comments such as "*this space is exactly what our community needs.*" We would like to thank the Board of Directors who are so very invested in this organization. As volunteers, your dedication, active engagement, participation and support are commendable. To our amazing team, foster parents, kin/kith parents, volunteers and employees. You have faced much complexity and unprecedented challenging times, always keeping the safety of children and youth and the wellbeing of families we are privileged to serve at the center of all you do.



Kim Kaumacher
Board Chair

Gisèle Hébert,
Executive Director



Here's where we are
growing.

05

Here's where we are
going.

Elmwood is a vibrant and multi-use hub which provides a safe, inclusive and positive environment for children, youth and their networks.

Elmwood is renovating the existing Beauchamp Youth Hub, youth pantry and gymnasium and is expanding its space to include a community kitchen, a tech lab, a boardroom, a youth art studio and a quiet lounge.



Steven Beauchamp wanted to continue making a difference and give back to the community he grew up in. In late 2022, Mr. Beauchamp was moved by the stories shared by youth and announced another 1.3M donation to help realize a redevelopment project at Elmwood.

The Society is forever grateful for the kindness and generosity that the Beauchamp family has shown, Elmwood would not be what it is today without their support.

- STEVEN BEAUCHAMP, ELMWOOD CHAMPION

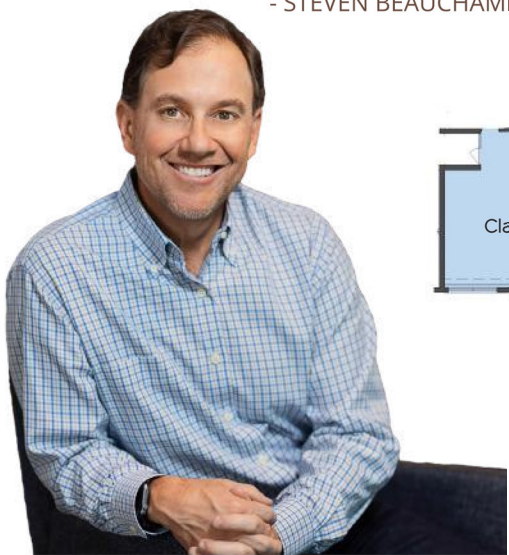
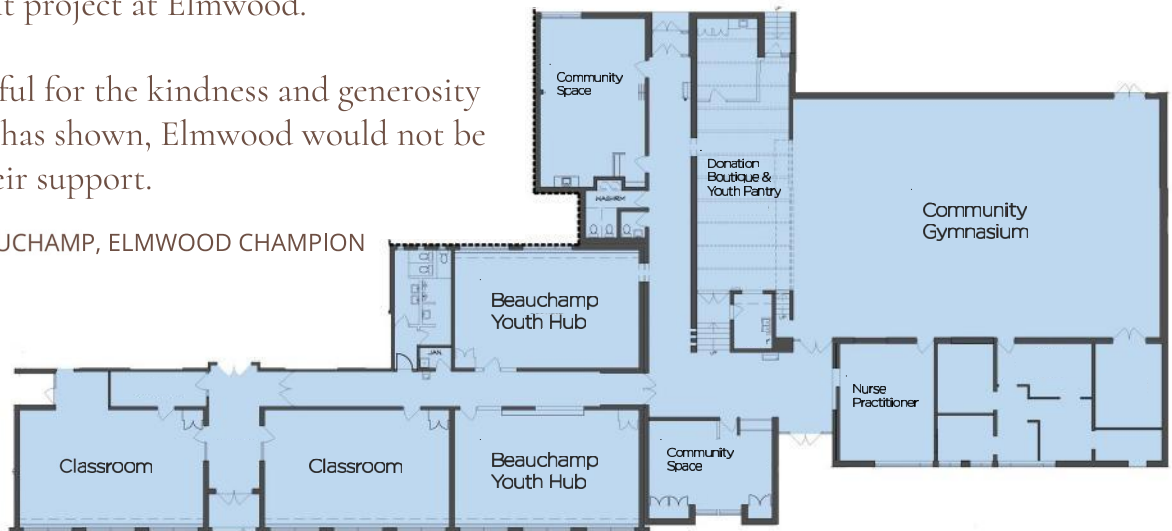

It has been tremendously valuable being able to gather together at Elmwood. We can reconnect and rebuild relationships and trust with our fellow community partners.

- COMMUNITY PARTNER

Service Snapshot

APRIL 2022 - MARCH 2023



1974

Child Protection Concerns
were Reported

56%

of reports required more intensive
child protection services.

15%

of families were
connected to other
community services.

13%

of families received longer
term, wrap-around services
(ongoing protection).

3%

of cases resulted in the need
for an alternative caregiver
arrangement.

91%

of children/youth are residing
in family-based care.

04

Flourishing Youth

CONNECTING YOUTH IN CARE WITH
SUPPORTS TO SUCCEED TO ADULTHOOD

The **Ready, Set, Go Program**, launched in April 2022 provides youth transitioning out of care (up to the age of 23) with the life skills, financial assistance and supports they need to pursue post-secondary education, skilled trades, training and employment opportunities.



To best serve our youth population, we provide comprehensive youth programming that focuses on four pillars.



34%

of youth served in
2022-2023 were over
the age of 16.



Nurturing Networks

OUR SIGNS OF SAFETY JOURNEY

Embedding the Signs of Safety practice is a journey, not an event. We are working alongside families, honouring them as experts in their experiences and valuing them as partners in developing plans together for their families. Here is how we are growing to keep children safe and promote permanency and well-being.

FAMILY PRESERVATION

Children and youth should be safe, healthy and live with their families, therefore we focus on preserving and reuniting families and building on the capacity of extended family and communities to support children, youth and families.

COLLABORATIVE SERVICE DELIVERY

We collaborate with families, community partners, and other stakeholders in building positive, respectful partnerships across integrated multidisciplinary teams and providing individualized, flexible and timely services to support these efforts.

STRENGTH BASED APPROACH

Our approach is reflective, culturally responsive and strengths based. Because all families have strengths and resources, we recognize and support the right and responsibility of parents to share in the decision-making process for them and their children.

CONTINUOUS QUALITY IMPROVEMENT

Our casework is transparent and we share information appropriately. Our approach is outcome oriented and evidence-based therefore we support innovative practice, evaluate our performance and strive for continuous improvement.





Children's Aid Society
La Société d'aide à l'enfance
NIPISSING & PARRY SOUND

The Children's Aid Society of the District of Nipissing and Parry Sound

433 MCINTYRE STREET WEST
NORTH BAY, ON P1B 2Z3
(877) 303-0910
PARNIPCAS.ORG

